

Hole arrangement for all 8mm thick mild steel plates welded between beam flanges by others.

SCALE 1:2

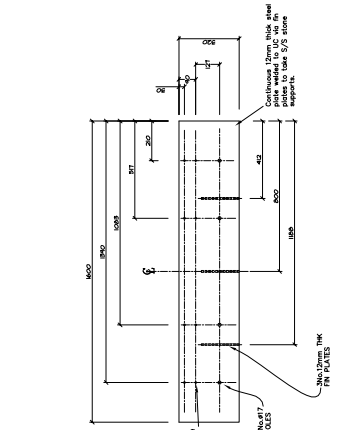

DETAIL SP1  
SCALE 1:10

**FOR CONSTRUCTION**

These drawings have been prepared in accordance with BS2908 1994, Design & Installation of Natural Stone Cladding and Lining.

**COM REGULATIONS**

**DESIGN RISK ASSESSMENT**

The size and shape of individual stones for this project have been designed to satisfy the overall design requirements for the building.

All persons handling and installing such stones should be aware that there are risks associated with this type of work, which cannot be designed out.

**Risk: Injury**

**Risk Reduction:**

There must be suitably experienced in the handling of stones and employ lifting methods appropriate to the size and shape of the stone.

Access and working platforms must be to the standards required by current legislation.

Reference must always be made to COSHH information for the materials being used.

**Notes:**

○ = To be confirmed  
 ○ 50 = Net Stone sizes  
 + 50 = Gross overall sizes

C	16/12/03	General update and change address.	TA
B	20/03/03	Secondary and finish details (by others), and stone mark.	TA
A	16/03/03	Issued for construction.	TA
Rev	02/05	Comments.	TA

**BATH STONE PRODUCTS LTD**  
 23 BISHOPSCOTE ROAD, WEST BRIDGEFORD  
 LEICESTERSHIRE LE16 9JG  
 TEL: 01933 412843 FAX: 01933 410374

**stewart design (uk) limited**  
 23 BISHOPSCOTE ROAD, WEST BRIDGEFORD, LEICESTERSHIRE, LE16 9JG  
 TEL: +44 (0) 1933 412843 FAX: +44 (0) 1933 410374  
 www.stewartdesign.co.uk email: enquiries@stewartdesign.co.uk

Project: Kingsmead Leisure Development Bath  
 Drawing Title: St James Street West Stone Detail  
 Main Elevation Grids 10 - 9  
 Date: Aug 03  
 Scale: 1:25 @ A4  
 Drawing Code: GA01